



**RE/MAX**  
Prime Estates



**101A Enville Street, Stourbridge, DY8 3TQ**  
**Offers in the region of £125,000**

Nestled on the charming Enville Street in Stourbridge, this delightful terraced house offers a perfect blend of comfort and convenience. With a modest yet well-designed living space of 474 square feet, this property is ideal for individuals or couples seeking a cosy home.

The location of this property is particularly appealing, as it is situated in a vibrant community with easy access to local amenities, including shops, parks, and public transport links. Stourbridge itself is known for its rich history and friendly atmosphere, making it a wonderful place to call home.

This terraced house presents an excellent opportunity for first-time buyers or those looking to downsize. With its charming features and prime location, it is a property that should not be missed. Whether you are seeking a peaceful abode or a base to explore the surrounding area, this home on Enville Street is sure to meet your needs.

## Approach



Door leading from the footpath.

## Living Room 9'0" x 15'11" (2.75 x 4.87)



With a door leading from the front, stairs ascending to the first floor, an opening into the kitchen. With a double glazed window to the front and a central heating radiator.

## Kitchen 9'4" x 8'2" (2.86 x 2.51)



With a range of wall and base units, a stainless steel sink and drainer, splashback tiling, laminate flooring, a double glazed window to the front and a central heating radiator.

## Bedroom 9'1" x 15'5" (2.78 x 4.72)



With a door leading to the bathroom, two storage cupboards, a double glazed window to the front and a central heating radiator.

## Bathroom



With a shower cubicle, wash hand basin, WC, central heating radiator and laminate flooring.

## Referral Fees

At RE/MAX Prime Estates, we are committed to full transparency in all aspects of our service.

As part of our commitment to supporting clients through the property transaction process, we may introduce you to third-party service providers, including conveyancers and mortgage advisers. Where such introductions are made, please note the following:

### Conveyancing Referrals:

Should you choose to instruct a solicitor or licensed conveyancer introduced by us, please be aware that RE/MAX Prime Estates may receive a referral fee for this introduction. This fee is typically up to £200 and is paid directly to us by the conveyancing firm. This fee is not an additional cost to you and does not affect the quote or service you receive. We only recommend firms we believe offer a high standard of service. You are under no obligation to use any of the professionals we recommend and are free to

choose an alternative provider.

#### Financial Services Referrals:

If we introduce you to an independent financial advisory firm, and you proceed with their services, RE/MAX Prime Estates may receive a referral fee averaging £218 per completed case. This referral fee is paid by the financial advisory firm and does not affect the fees or products offered to you. As with all our recommendations, you are under no obligation to proceed with any advisor we introduce.

We are happy to provide further details on referral arrangements upon request.

#### [Money Laundering Regulation](#)

Under the UK's Money Laundering, Terrorist Financing and Transfer of Funds (Information on the Payer) Regulations 2017 (MLR 2017), estate agents are legally required to conduct Customer Due Diligence (CDD) on both sellers and buyers when a business relationship is established. This involves verifying the identity of all beneficial owners and individuals involved in the transaction. HM Revenue & Customs (HMRC) supervises estate agents for compliance with these regulations.

To meet these obligations, RE/MAX Prime Estates employs a third-party provider to perform Anti-Money Laundering (AML) checks. A fee of £50 plus VAT per individual over the age of 18 is charged to cover the cost of these checks.

## Floor Plan

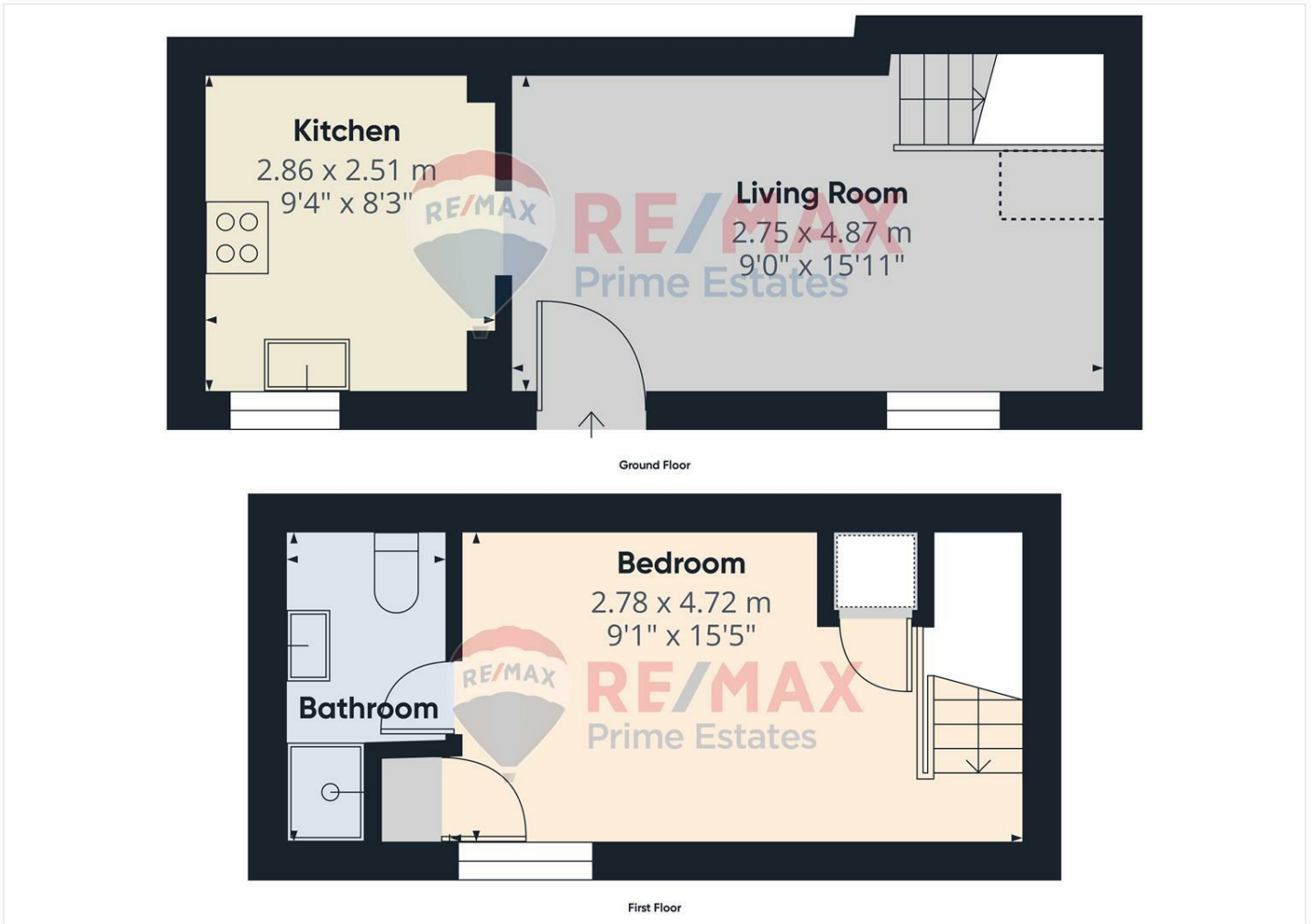

## Area Map

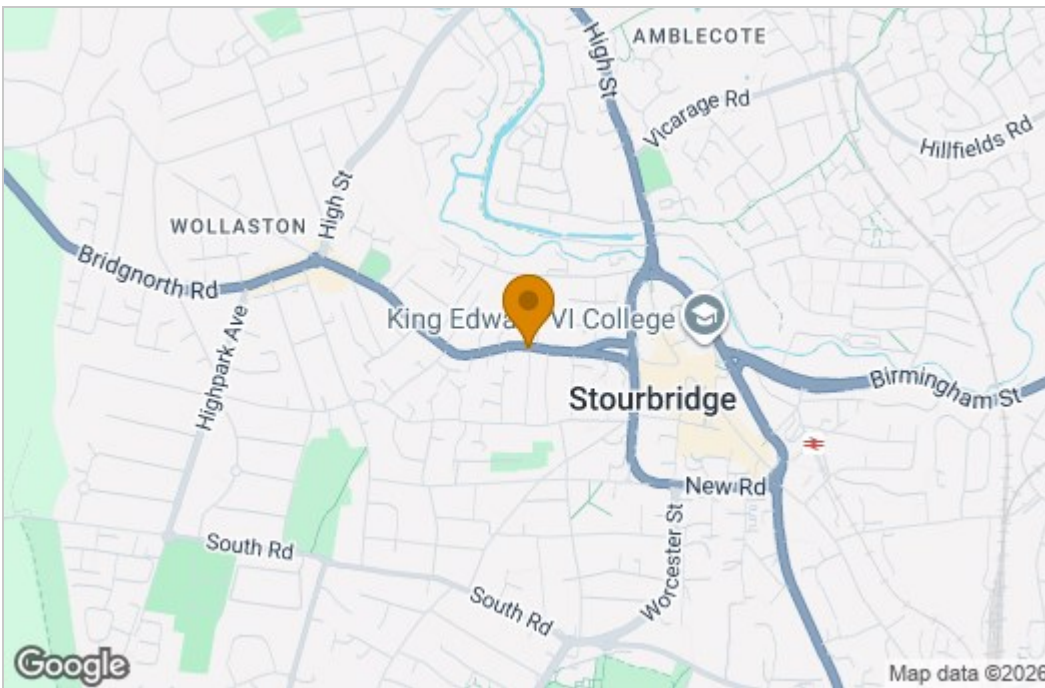

## Energy Efficiency Graph

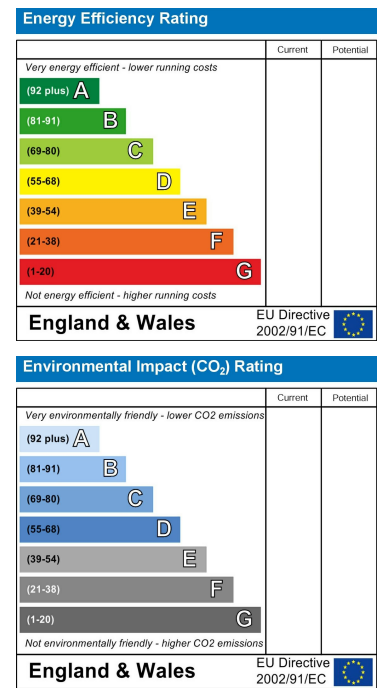

These particulars, whilst believed to be accurate are set out as a general outline only for guidance and do not constitute any part of an offer or contract. Intending purchasers should not rely on them as statements of representation of fact, but must satisfy themselves by inspection or otherwise as to their accuracy. No person in this firm's employment has the authority to make or give any representation or warranty in respect of the property.

Stourbridge, West Midlands, DY8 1DX

Tel: +44 (0) 1384 438457 Email: [prime.estates@remax.uk](mailto:prime.estates@remax.uk) <https://remax.uk/locations/RE-MAX-Prime-Estates>